

JUNE 18-19 1977

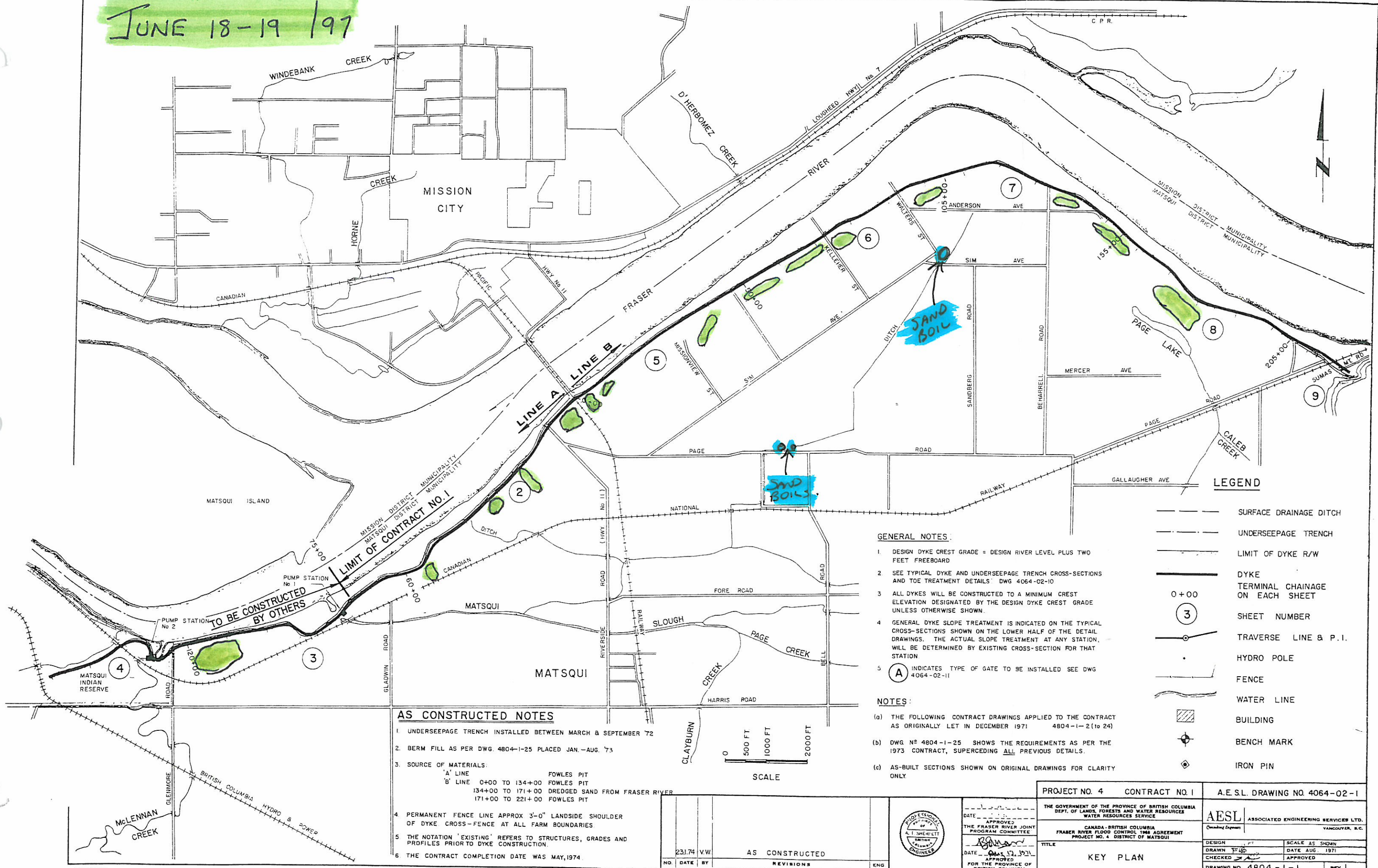

**GENERAL NOTES:**

- DESIGN DYKE CREST GRADE = DESIGN RIVER LEVEL PLUS TWO FEET FREEBOARD
- SEE TYPICAL DYKE AND UNDERSEEPAGE TRENCH CROSS-SECTIONS AND TOE TREATMENT DETAILS DWG 4064-02-10
- ALL DYKES WILL BE CONSTRUCTED TO A MINIMUM CREST ELEVATION DESIGNATED BY THE DESIGN DYKE CREST GRADE UNLESS OTHERWISE SHOWN.
- GENERAL DYKE SLOPE TREATMENT IS INDICATED ON THE TYPICAL CROSS-SECTIONS SHOWN ON THE LOWER HALF OF THE DETAIL DRAWINGS. THE ACTUAL SLOPE TREATMENT AT ANY STATION WILL BE DETERMINED BY EXISTING CROSS-SECTION FOR THAT STATION
- (A) INDICATES TYPE OF GATE TO BE INSTALLED SEE DWG 4064-02-11

**NOTES:**

- THE FOLLOWING CONTRACT DRAWINGS APPLIED TO THE CONTRACT AS ORIGINALLY LET IN DECEMBER 1971 4804-1-2 (1 to 24)
- DWG No 4804-1-25 SHOWS THE REQUIREMENTS AS PER THE 1973 CONTRACT, SUPERCEDING ALL PREVIOUS DETAILS.
- AS-BUILT SECTIONS SHOWN ON ORIGINAL DRAWINGS FOR CLARITY ONLY

**LEGEND**

- SURFACE DRAINAGE DITCH
- UNDERSEEPAGE TRENCH
- LIMIT OF DYKE R/W
- DYKE
- 0+00 TERMINAL CHAINAGE ON EACH SHEET
- ③ SHEET NUMBER
- TRVERSE LINE & P.I.
- HYDRO POLE
- FENCE
- WATER LINE
- ▨ BUILDING
- ⊕ BENCH MARK
- ⊙ IRON PIN

**AS CONSTRUCTED NOTES**

- UNDERSEEPAGE TRENCH INSTALLED BETWEEN MARCH & SEPTEMBER 72
- BERM FILL AS PER DWG. 4804-1-25 PLACED JAN.-AUG. 73
- SOURCE OF MATERIALS:  
 'A' LINE 0+00 TO 134+00 FOWLES PIT  
 'B' LINE 134+00 TO 171+00 DREDGED SAND FROM FRASER RIVER  
 171+00 TO 221+00 FOWLES PIT
- PERMANENT FENCE LINE APPROX 3'-0" LANDSIDE SHOULDER OF DYKE CROSS-FENCE AT ALL FARM BOUNDARIES
- THE NOTATION 'EXISTING' REFERS TO STRUCTURES, GRADES AND PROFILES PRIOR TO DYKE CONSTRUCTION.
- THE CONTRACT COMPLETION DATE WAS MAY, 1974

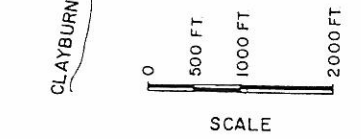

231.74	V.W.	AS CONSTRUCTED	ENG
NO.	DATE	BY	REVISIONS



DATE \_\_\_\_\_  
 APPROVED  
 THE FRASER RIVER JOINT  
 PROGRAM COMMITTEE  
 DATE \_\_\_\_\_  
 APPROVED  
 FOR THE PROVINCE OF  
 BRITISH COLUMBIA

PROJECT NO. 4	CONTRACT NO. 1	A.E.S.L. DRAWING NO. 4064-02-1
THE GOVERNMENT OF THE PROVINCE OF BRITISH COLUMBIA DEPT. OF LANDS, FORESTS AND WATER RESOURCES WATER RESOURCES SERVICE		AESL ASSOCIATED ENGINEERING SERVICES LTD. Vancouver, B.C.
CANADA-BRITISH COLUMBIA FRASER RIVER FLOOD CONTROL TREATY AGREEMENT PROJECT NO. 4 DISTRICT OF MATSQUI		TITLE
DESIGN	SCALE AS SHOWN	
DRAWN	DATE AUG. 1971	
CHECKED	APPROVED	
DRAWING NO. 4804-1-1		REV. 1